

## 1715 Storability® 31"W x 4"H x 6-1/2"D Wire Basket

Read all instructions completely before installing. Should you have any questions about your installation, please call Customer Service at 440-248-5480. Missing and damaged parts must be reported within 5 days from receipt of delivery.

Tools needed for this installation (not supplied with kit) - Level – Tape Measure

### Parts Listing

Part Number	Quantity	Description
1715	1	31" Wire Basket
	1	Left Lock-On Hanging Bracket
	1	Right Lock-On Hanging Bracket

Model 1715 31" Wire basket will mount onto 2 hang rail sections spaced 30-3/8" apart measured inside (between) the hang rails. Top Track Model 1700 and Hang Rail Model 1701 sold separately.)

**Accessory Installation:** (See image below) Attach left and right lock-on hanging brackets and install into the identical height slots in both hang rails spaced 30-3/8" I.D. Binding can occur if not level. Wire basket will be installed in the inside slot positions of each hang rail. If accidental binding occurs use soft rubber mallet to help remove accessory and protect the surface coating.

Note: Attach back of brackets first, then front

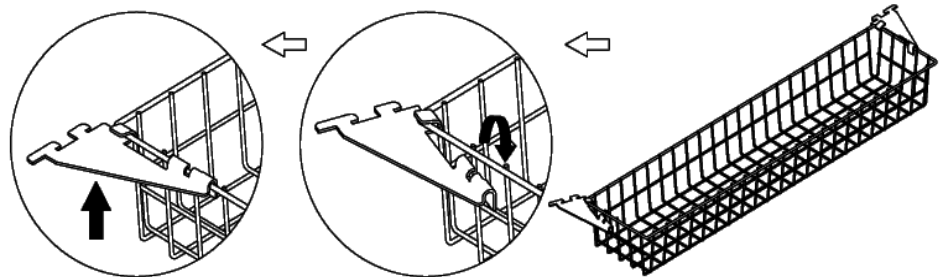

Attach brackets to hang rail at 45° angle as shown in photo below

